

4

3

2

1

D

D

C

C

B

B

A

A

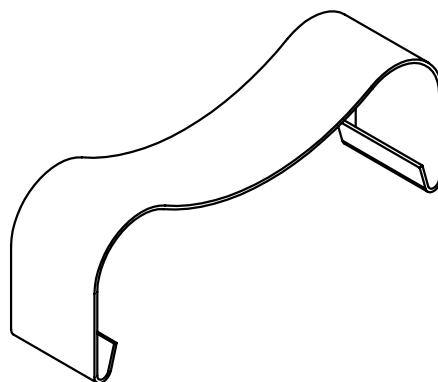
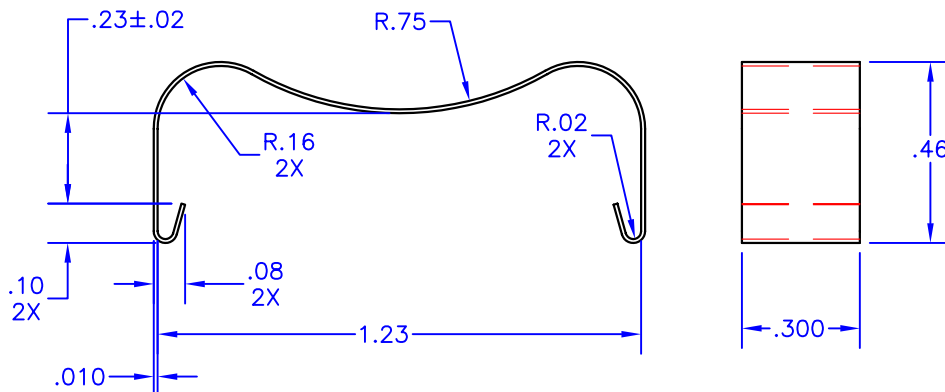
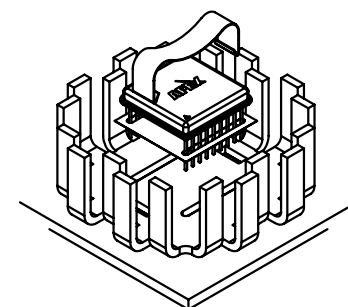

NOTES:

1. Unless otherwise noted, dimensions are in inches.
2. Break all sharp edges, de-burr and remove loose chips.
3. Material: $.010$ thick 302 stainless, full hard
4. Finish: None
5. Used with HS21 heatsink.
6. Approximate weight: $.03$ oz. [.85 g]

TOLERANCES - UNLESS OTHERWISE SPECIFIED	
.XX	= $\pm .01$
.XXX	= $\pm .005$
ANG.	= $\pm .5^\circ$



TITLE CLAMP, DIP				PART NO. CLAMP02	
SUBJECT MECHANICAL DRAWING					
ENG. D-M	TECH/DWN. D-M	DCA 46333	SH. OF 1 1	FILENAME CLAMP02-C	REV C
				DATE 10/04/04	

4

3

2

1